

CUSTOMER		IKP P/N	LF-EQ261500-0R8R
----------	--	---------	------------------

MECHANICAL DIMENSION: (UNIT:mm)

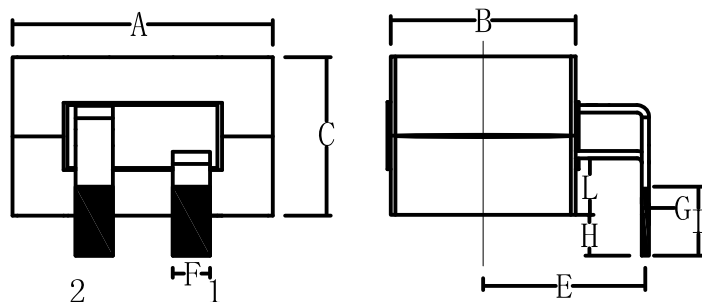

DIMENSION: (mm)

- A: 27.2 MAX
- B: 19.8 MAX
- C: 16.0 MAX
- D: 10.4±0.4
- E: 15.0±0.5
- F: 3.5<sup>+0.1</sup><sub>-0.3</sub>
- G: 1.15±0.15
- H: 3.3±0.5
- I: 5.0 MIN
- J: 21.0 MAX
- L: 3.15 MIN

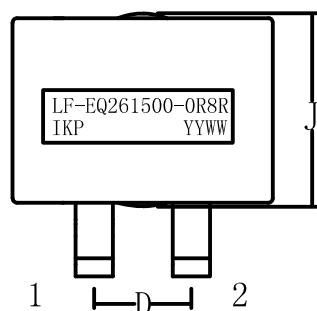

WINDING STEP:

WDG	TERMINAL	WIRE GAUGE	TURNS	REMARKS
N1	1--2	1EIW-H 1.15mm*3.5mm	7TS	

ELECTRICAL CHARACTER:

NO.	ITEM	Measured Point	Technical Data	Test Condition & Instrument
1	INDUCTANCE	L(1--2)	10.0uH±10%	CH3302 320X (100KHz, 0.1V 25°C)
2	Inductance at Saturation Current	L1 (1--2) MMCR≥90%	I <sub>SAT</sub> =35A I1=0A I2=30A @25°C	DPG10 EDK parameters: 50A, 60V, 1000us MMCR= $\frac{L_{I\_SAT}}{\text{Average\_LI1-I2}}$
		L2 (1--2)	I <sub>SAT</sub> =27.5A I1=0A I2=23A @125°C	
3	AC Resistance	R(1--2)	70mΩ MAX	TH2829LX (200KHz 0.1V 25°C)
4	DCR	R(1--2)	2.0mΩ MAX	Hanker 502BC (@20°C)
5	HI-POT	COIL TO CORE	AC300V	50Hz, 5mA, 2S CS2672

Note: Operationing temp -40°C to 125°C



DESIGN BY	DRAWN BY	CHECKED BY	APPROVED BY	CUSTOMER P/N:	
				DOCUMENT NO./Rev.	
				DATE	2018-08-06
				SHEET_OF_	1 / 1